

Definition – Combi Pinholes for Saw Blades

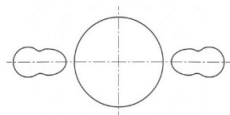

CPH1	$2/7/42 + 2/10/60$
CPH2	$2/7/42 + 2/9/46,4 + 2/10/60$
CPH3	$2/9/46,4 + 2/10/60$
CPH4	$2/7/42 + 2/9/46 + 2/9,5/46,5 + 2/10/60 + 2/13/94$
CPH5	$2/7/110 + 2/9/110 + 2/8,4/130 + 2/14/110 + 4/9/100 + 4/19/120$
CPH6	
CPH7	$2/10/80 + 2/11/115 + 2/14/125 + 2/19/120 + 2/11/85 + 2/11/148 + 2/14/100$
CPH8	