

TESA MICRO-HITE 350 / 600 / 900 Height Gauge Sets



No		
00730033	TESA MICRO-HITE height gauge set	350
00730034	TESA MICRO-HITE height gauge set	600
00730035	TESA MICRO-HITE height gauge set	900

Each gauge set includes the following components, control panel excluded:

00730021	1 TESA MICRO-HITE 350 main gauge	●		
00730022	1 TESA MICRO-HITE 600 main gauge		●	
00730023	1 TESA MICRO-HITE 900 main gauge			●
00760143	1 Standard probe insert holder	●	●	●
00760227	1 Standard probe insert with shank and 5 mm dia. ball tip in tungsten carbide	●	●	●
00760150	1 Master piece for establishing the probe constant, nominal dimension 20,0000 mm/0.78740 in	●	●	●
00760142	1 Electric pump for creating the air-cushion beneath the gauge base, already mounted	●	●	●
00760141	1 Battery pack	●	●	●
04761054	1 Mains adapter, 100 to 240 Vac/50 to 60 Hz	●	●	●
04761055	1 Cable EU for mains adapter	●	●	●
00760151	1 Dust cover for TESA MICRO-HITE 350	●		
00760152	1 Dust cover for TESA MICRO-HITE 600		●	
00760153	1 Dust cover for TESA MICRO-HITE 900			●

Optional Accessories for TESA MICRO-HITE 350 / 600 / 900

00760144	Add-on fine adjust device for extra fine movement of the measuring head, complete
00760157	Spare battery pack No. 00760141
04761056	Cable US for mains adapter
04761023	RS 232 connecting for PC and TESA PRINTER SPC

For additional accessories, see pages N-20 and N-27.

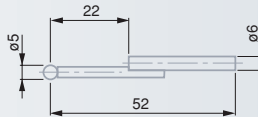

00760227

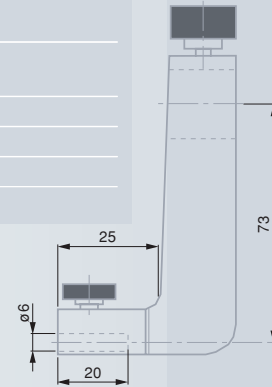

00760143

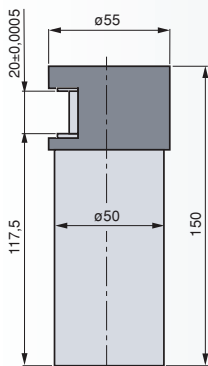

00760150

Technical Data

Models		350	600	900
	mm	365	615	920
	in	14	24	36
With standard accessory	mm	0 ÷ 520	0 ÷ 770	0 ÷ 1075
	in	0 ÷ 20	0 ÷ 30	0 ÷ 42
With probe insert holder No. 00760057	mm	0 ÷ 575	0 ÷ 825	0 ÷ 1130
	in	0 ÷ 22	0 ÷ 32	0 ÷ 44
With probe insert holder No. S07001622	mm	0 ÷ 745	0 ÷ 995	0 ÷ 1300
	in	0 ÷ 29	0 ÷ 39	0 ÷ 51
With standard accessory		(2 + 3•L) μm (0.0001 + 0.000003•L) in		(L in m) (L in in)
With standard accessory		2δ = ≤1 μm / ≤0.00005 in		
Frontal, mechanical	μm	7	9	11
	in	0.00028	0.00035	0.00043
Frontal and lateral using TESA IG-13	μm	6	8	10
	in	0.00024	0.00031	0.00039