

TESA-HITE plus M 400 / 700

Precision in Motion – Motorised Version

The added value of the motorised TESA-HITE plus M 400 / 700 is not only noticeable in their technical features, but also in their ease of use. Combine with the programming function, this solution is ideal for recurrent measurements in the shop floor environment. Advanced functions allow for complex calculations such as those required for two-axis or perpendicularity measurement. These height gauges with outstanding features offer the most attractive price/performance relationship, making them indispensable for the workshop.



- Wide application range.
- Electronics entirely protected from the penetration of liquids and dust particles.
- Integrated air cushion, mounted control panel.
- Easy, intuitive use of the rotary power control.
- Provide all the measuring functions of a dedicated motorised column, including height, diameter, distance, parallelism, perpendicularity, straightness, angle and 2D measurement besides programming, automatic probing cycles, statistical value processing.
- TESA's patented measuring system, opto-electronic.
- Probe insert holder and inserts compatible with those of TESA MICRO-HITE.
- SCS calibration certificate attached to each height gauge.



Factory standard

Dual LC display, 128 x 63 mm in size.

• Upper display field for length values (7 segments/sign). Also with symbols for the functions.

• Lower full dot display field for perpendicularity and straightness along with symbols for all operator-controlled function keys.

7 segment display plus minus sign for the measured values.

0,0001 / 0,001 / 0,01 mm or 0,00001 / 0,0001 / 0,001 in

Main display with a size to 12,7 x 6,4 mm or 6,3 x 4,2 mm for auxiliary display.

Metric/Inch conversion

Air bearing for easy displacement on the granite plate.

For measuring span, application range and precision: see the table on page N-11. 30 function keys available on the keyboard.

Rugged nickel plated gauge base having 3 resting points, finely lapped.

Frontal for models
400 = < 8 μm
700 = < 12 μm

Incremental glass scale, opto-electronic data capture

(12 ± 1,5) x 10⁴ K⁻¹

Measuring head mounted on a ball-bearing. Electro-motorised head displacement at varying speeds from 7,5 up to 40 mm/s. Manual displacement: ≤ 600 mm/s. Automatic value acquisition with a constant measuring force.

1 N. Coupled servomotor for triggering the measuring force.

RS 232

Rechargeable batteries, 6V

≈ 60 h, full charging takes 8 hours





Standard accessories for
TESA-HITE plus M 400 / 700

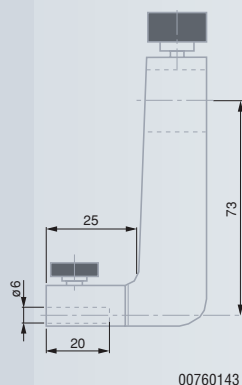

00760143

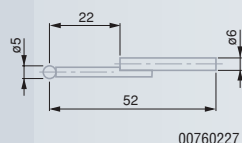

00760227



10°C to 40°C



-10°C to 60°C

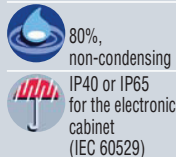

80%, non-condensing
IP40 or IP65
for the electronic cabinet
(IEC 60529)



See table
opposite



EN 61326,
class B (with
disconnected
battery charger)



Shipping
packaging



Identification
number



Declaration
of conformity



SCS
calibration
certificate

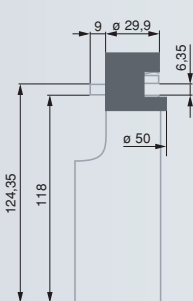

00760219

TESA-HITE plus M 400/700

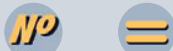

- 00730045** TESA-HITE plus M 400 height gauge
Measuring span 405 mm / 16 in
Application range 0 to 560 mm / 0 to 22 in
- 00730046** TESA-HITE plus M 700 height gauge
Measuring span 755 mm / 27 in
Application range 0 to 860 mm / 0 to 33 in
- 00730057** TESA-HITE plus M 400 height gauge with built-in printer
Same as N° 00730045, but with a built-in matrix printer for results output.
- 00730058** TESA-HITE plus M 700 height gauge with built-in printer
Same as N° 00730046, but with a built-in matrix printer for results output.

Each height gauge is supplied with the following standard accessories:

- 00760143** 1 Probe insert holder
- 00760227** 1 Standard probe insert with shank and 5 mm dia. ball tip in tungsten carbide
- 00760219** 1 Master piece for establishing the probe constant, nominal dimension : 6,350 mm / 0.2500 in
- 00760226** 1 Electric pump for creating the air cushion under the height gauge base, already mounted
- 00760157** 1 Rechargeable battery, 6V
- 00761054** 1 Mains adapter, 100 ÷ 240 Vac / 50 ÷ 60 Hz
- 00761055** 1 Cable EU for mains adapter
- 00761056** 1 Cable US for mains adapter

Technical Data

		TESA-HITE plus M 400	TESA-HITE plus M 700
	mm in	405 16	705 27
	mm in	0 ÷ 560 0 ÷ 22	0 ÷ 860 0 ÷ 33
With probe insert holder N° 00760057	mm in	0 ÷ 615 0 ÷ 24	0 ÷ 915 0 ÷ 35
With probe insert holder N° S07001622	mm in	0 ÷ 785 0 ÷ 31	0 ÷ 1085 0 ÷ 42
	µm in	(0.0001+0.000003 • L) in (L in in)	
		on flat surfaces: 2δ = < 1 µm / < 0.00005 in into bores: 2δ = < 2 µm / < 0.0001 in	
	µm in	8 0.00031	12 0.00047
	kg	27	32

Optional Accessories for TESA-HITE plus M 400 / 700

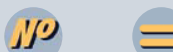

- 04760070** RS port. Used to connect a digital sensor for perpendicularity measurement
- 04761052** RS 232 connecting cable for PC and TESA PRINTER SPC
- 04761063** Connecting cable with Sub-D connector 9-pin – USB type for PC
- 04765008** Thermal paper roll, 57 mm wide
For additional accessories, report to page N-27

