

Measuring insert with offset (A) contact point and lock nut for radial alignment.

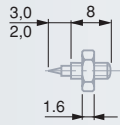

03560063 Steel 12



Measuring insert with needle contact point.

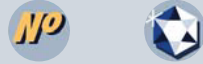

03560030 Steel

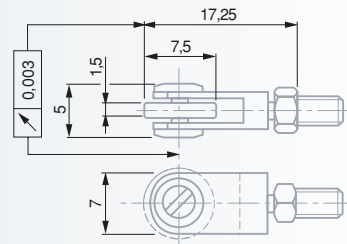

Measuring inserts with ball-bearing rollers. Lock nut for radial alignment.



03560010 Steel cylindrical
03560011 Steel ball-shaped

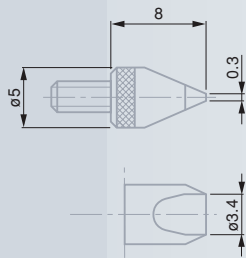

Inserts with a blade-shaped measuring face. Lock nut for radial alignment.



03560024 Steel 0,3
03560025 Carbide 0,3

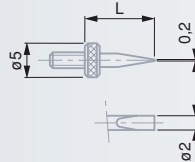

Inserts with a blade-shaped steel face. Lock nut for radial alignment.

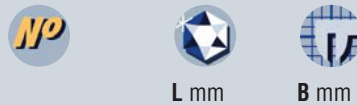

03560031 5 0,2
03560032 10 0,2
03560033 15 0,2
03560034 20 0,2

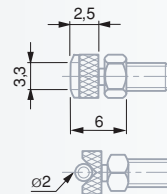

Insert with a cylindrical measuring face. Lock nut for radial alignment.

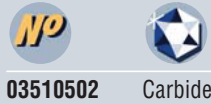

03510502 Carbide

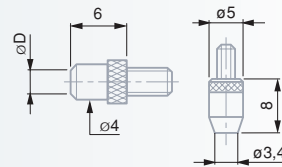

Inserts with a flat measuring face.



03510801 Steel 2,5
03510802 Carbide 2,5
03560022 Steel 3,4
03560023 Carbide 3,4

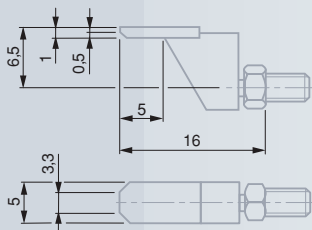

Insert with a narrow, off-centre measuring face. Lock nut for radial alignment.



03510602 Carbide 0,5

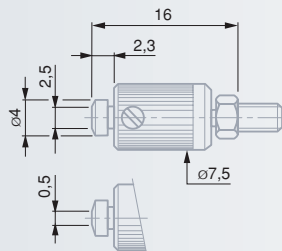

Insert with a narrow, parallel measuring face, adjustable. Lock nut for radial alignment.



03510702 Carbide 0,5

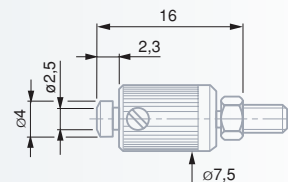

Insert with a flat, parallel measuring face., adjustable. Lock nut for radial alignment.

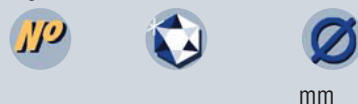

03510902 Carbide 2,5

