

# Measuring Inserts for Dial Gauges, Axial Probes and other Handtools

Executions with a M2,5 coupling thread

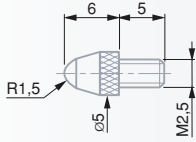

Standard spherical measuring inserts.

No	Material	L mm
03510001	Steel	6
03510002	Carbide	6
03560001	Sapphire	6

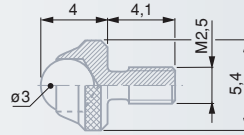

Short spherical measuring insert.

No	Material	L mm
03560007	Carbide	4

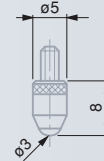

Long spherical measuring inserts.

No	Material	L mm
03560019	Steel	8
03560020	Carbide	8
03560021	Sapphire	8

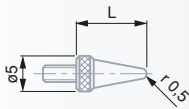

Spherical measuring inserts,  
R = 0,5 mm.

No	Material	L mm
03560035	Steel	5
03560036	Steel	10
03560037	Steel	15
03560038	Steel	20
03560039	Steel	30
03560040	Steel	40

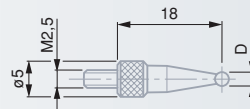

Spherical measuring inserts.

No	Material	mm
03560051	Carbide	1
03560052	Carbide	2
03560053	Carbide	3
03560054	Carbide	4
03560055	Carbide	5
03560056	Carbide	6
03560057	Carbide	7
03560058	Carbide	8
03560059	Carbide	9
03560060	Steel	10
03560061	Steel	11
03560062	Steel	12

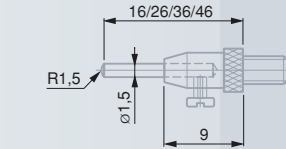

Spherical measuring insert with  
4 interchangeable pins, R = 1,5 mm.

No	Material	L mm
03510201	Steel	16, 26, 36, 46

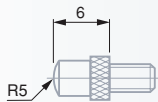

Spherical measuring inserts.

No	Material	R mm
03510101	Steel	5
03510102	Carbide	5

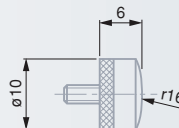

Spherical measuring inserts

No	Material	R mm
03560017	Steel	16
03560018	Carbide	16

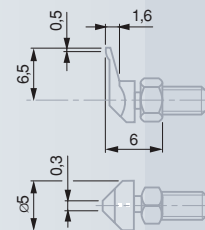

Measuring insert with offset (A)  
contact point and lock nut for radial  
alignment.

No	Material	A mm
03510401	Steel	6,5