

# Long Range Precision Dial Gauges

0,01 mm dial readout / 58 mm dial diameter

Both models 0141760635 and 0141760636 are particularly profitable.



EN ISO 463  
Factory  
standard



0,01 mm



1,5 mm



Rotating dial



Full-metal  
dial casing.  
Stainless steel  
fixing shank and plunger,  
hardened.



With or without  
shockproof  
mechanism



Adjustable  
tolerance  
marks.

Model No. 0141760640  
with fine adjust mounted  
under the protective cap  
for dial reading.  
M2.5 mounting thread for  
the measuring insert.



For accuracy,  
see table on  
page F-22



See table  
opposite



Mounted insert  
with a 3,175 mm  
dia. steel ball tip.

Exception:  
Each model No. 0141760631  
has a ruby ball tip.



Plastic case or  
cardboard box



Identification  
number



Declaration  
of conformity



mm



mm



mm



mm



mm



mm



N

### ROCH dial gauges

<b>0141760631</b>	0,01	10	10,5	—	1	0 ÷ 50 ÷ 100*	≤ 1,4
<b>0141760635</b>	0,01	10	10,5	—	1	0 ÷ 50 ÷ 100*	≤ 1,4
<b>0141760636****</b>	0,01	10	10,5	—	1	0 ÷ 50 ÷ 100*	≤ 1,4
<b>0141760640</b>	0,01	10	10,5	●	1	0 ÷ 50 ÷ 100*	≤ 1,4
<b>0141761213***</b>	0,01	15	15,5	●	1	0 ÷ 50 ÷ 100*	≤ 1,6
<b>0141760651</b>	0,01	30	30,5	—	1	0 ÷ 50 ÷ 100	≤ 1,6
<b>0141760653</b>	0,01	30	30,5	●	1	0 ÷ 50 ÷ 100	≤ 1,6
<b>0141760661</b>	0,01	50	51	—	1	0 ÷ 50 ÷ 100	≤ 2,2
<b>0141760662**</b>	0,01	50	51	—	1	0 ÷ 50 ÷ 100	≤ 2,2
<b>0141760663</b>	0,01	50	51	●	1	0 ÷ 50 ÷ 100	≤ 2,2
<b>0141760671</b>	0,01	80	81	—	1	0 ÷ 50 ÷ 100	≤ 3,0

### ROCH IP54 dial gauge, protected against the penetration of liquids

<b>0141760624</b>	0,01	10	10,5	●	1	0 ÷ 50 ÷ 100*	≤ 2
-------------------	------	----	------	---	---	---------------	-----

\* With extra red tinted reverse numbering.

\*\* Counterclockwise numbering.

\*\*\* 60,4 mm dial diameter.

\*\*\*\* With mounted central lug back.

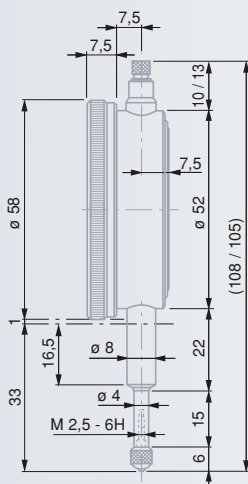

0141760631  
0141760635  
0141760636

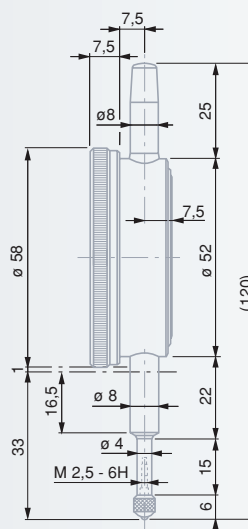

0141760640

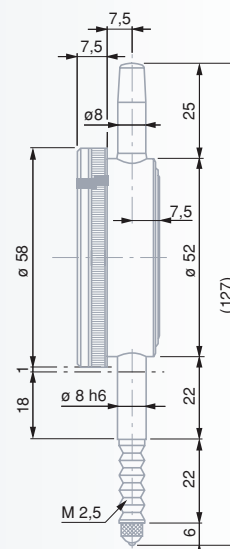

0141760624

