

## Precision Dial Gauges

0,01 mm dial readout / 57 or 58 mm dial diameter



EN ISO 463  
Factory standard



0,01 mm



1,5 mm



Rotating dial.  
Regular models with or without dial lock.



Full-metal dial casing.  
Stainless steel fixing shank and plunger, hardened.



With or without shockproof mechanism



Adjustable tolerance marks. M2,5 mounting thread for the measuring insert.



3 mm dia. ball tip, already mounted



Cardboard box



Identification number



Inspection report with a declaration of conformity



TESA dial gauges

01410610	YR	0,01	10	10,5	●	●	1	0 ÷ 50 ÷ 100
01410611	YR	0,01	10	10,5	●	●	1	0 ÷ 50 ÷ 0
01412310	YE	0,01	10	10,5	–	–	1	0 ÷ 50 ÷ 100

MERCER dial gauges

01416020	250-1	0,01	10	10,5	–	●	1	0 ÷ 50 ÷ 0
01416021	251-1	0,01	10	10,5	–	●	1	0 ÷ 50 ÷ 100

TESA IP54 dial gauges, protected against the penetration of liquids

01410721	YR	0,01	10	10,5	●	–	1	0 ÷ 50 ÷ 0
01412411	YE	0,01	10	10,5	–	–	1	0 ÷ 50 ÷ 100

TESA dial gauge with limited reading range

01412211	YE	0,01	± 0,4	4	●	–	1,27	40 ÷ 0 ÷ 40
----------	----	------	-------	---	---	---	------	-------------

### Permissible limits of a metrological characteristic (MPE/MPL)

	± 0,4	10 mm
Deviation span	7 μm	15 μm
Deviation span within the local measuring span 0,10 mm	5 μm	8 μm
Total deviation span	9 μm	17 μm
Repeatability limit	3 μm	3 μm
Max. hysteresis	3 μm	3 μm
Measuring force – Models IP54	≤ 1 N	≤ 1,5 N
	–	≤ 2,2 N

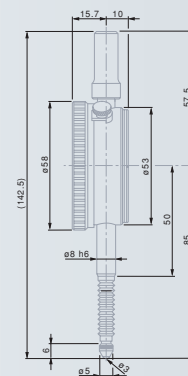

01410721 – 01412411

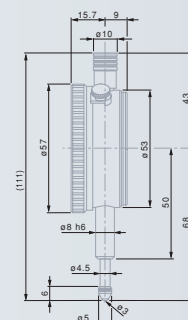

01410610 – 01410611