

## Precision Dial Gauges

0,1 mm dial readout / 40, 58 or 80 mm dial diameter



EN ISO 463  
Factory standard

0,1 mm

1,1 mm (40 mm dia.)  
1,5 mm (58 mm dia.)  
2,2 mm (80 mm dia.)

Rotating dial

Full-metal dial casing.  
Stainless steel fixing shank and plunger, hardened.

Without shockproof mechanism

M2,5 mounting thread for the measuring insert

See table opposite

Mounted insert with a 3,175 mm dia. steel ball tip

Suited plastic case

Identification number

Declaration of conformity

NO	mm	mm	mm	mm	mm	mm	N	
<i>ROCH dial gauges</i>								
0141760500	40	0,1	10	10,5	-	10	0 ÷ 5 ÷ 10	≤ 1,0
0141760501	58	0,1	10	10,5	-	10	0 ÷ 5 ÷ 10	≤ 1,0
0141760502	58	0,1	20	20,5	-	10	0 ÷ 5 ÷ 10	≤ 1,0
0141760503	58	0,1	30	30,5	-	10	0 ÷ 5 ÷ 10	≤ 1,5
0141760513	80	0,1	30	30,5	-	10	0 ÷ 5 ÷ 10	≤ 2,0

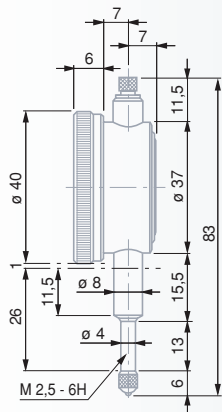

0141760500

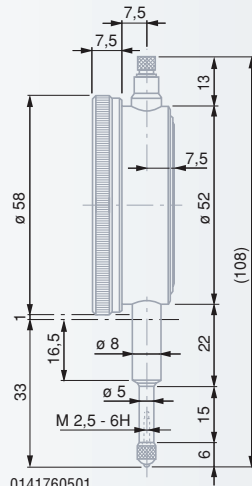

0141760501

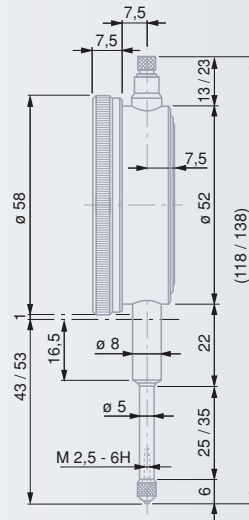

0141760503  
Similar model:  
0141760502

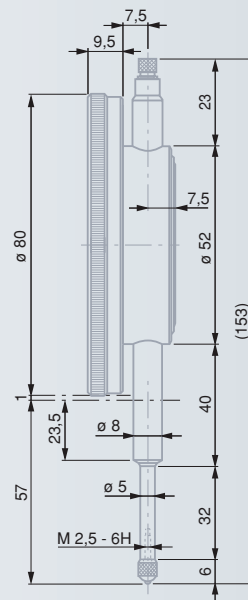

0141760513

### Maximum permissible errors for a metrological characteristic (MPE)

0,1 mm	10 mm
Deviation span	40 µm
Deviation span within the local measuring span of 1 mm	25 µm
Total deviation span	55 µm
Repeatability limit	15 µm
Max. hysteresis	15 µm