

TESA TRI-O-BOR

Self-centring and self-aligning internal micrometers with 3-line contact with the part being inspected. These micrometers measure trough holes, blind bores and short centring shoulders.

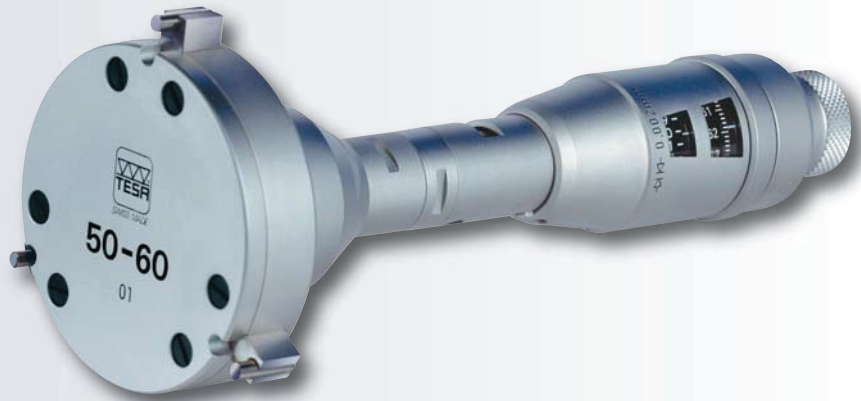

DIN 863 T4
(Style C2)
NF E 11-099

0,002 mm

0,01 mm

Tungsten carbide tipped measuring bolts and cone

Supplied with 1 heat insulating sleeve (No. 00940020), 2 keys (No. 00940001), 1 screwdriver (No. 00862801).

Shipping box

Identification number

Inspection report with a declaration of conformity



Measuring Bolts with Special Design

Used for ISO metric threads (M16 x 0,5 to M150 x 6), UN, UNC or UNF unified imperial threads (60°) and Whitworth threads (55°). Measuring bolts with special profiles can also be made available. Both the size and type of the thread or the workpiece to be measured must be specified in your inquiries or purchase orders (see drawings).

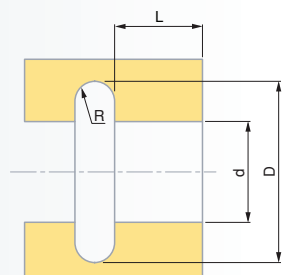
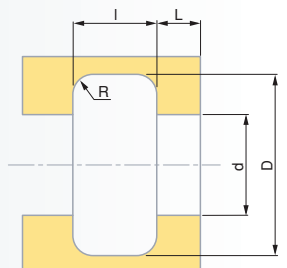
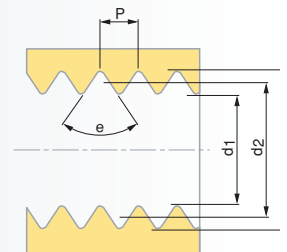
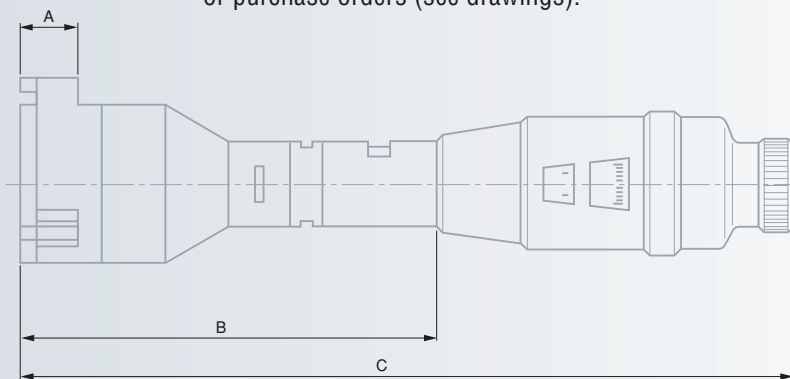

No	mm	µm	µm	A mm	B mm	C mm
00910005	15 ÷ 20	4	4	6	≥ 66	≤ 132
00910006	20 ÷ 25	4	4	6	≥ 66	≤ 132
00910007	25 ÷ 30	4	4	6	≥ 66	≤ 132
00910405	30 ÷ 40	4	4	10	≥ 70	≤ 138
00910406	40 ÷ 50	4	4	10	≥ 70	≤ 138
00910407	50 ÷ 60	5	5	10	≥ 70	≤ 138
00910705	60 ÷ 70	5	5	18	≥ 78	≤ 147
00910706	70 ÷ 80	5	5	18	≥ 78	≤ 147
00910707	80 ÷ 90	5	5	18	≥ 78	≤ 147
00911105	90 ÷ 100	5	5	18	≥ 78	≤ 147
00911106	100 ÷ 110	6	6	18	≥ 78	≤ 147
00911107	110 ÷ 120	6	6	18	≥ 78	≤ 147